

Height & tray adjustments unlock easily, yet lock into place & stay locked because of the Wedge-Lok System. The metal plate features wedge-cut edges that conform to the wedge-cut sections of the hardwood. When the knob is tightened, the inward tension pulls the metal plate snugly against the wood for a solid lock.

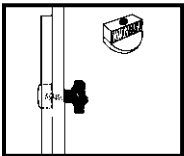

Slide Guides make angle and height adjustments on Best easels smooth. These circular graphite impregnated plastic inserts are used wherever there is a slot in the wood of the easel. This part allows for

smooth movement and protects the hardwood from the metal bolt.

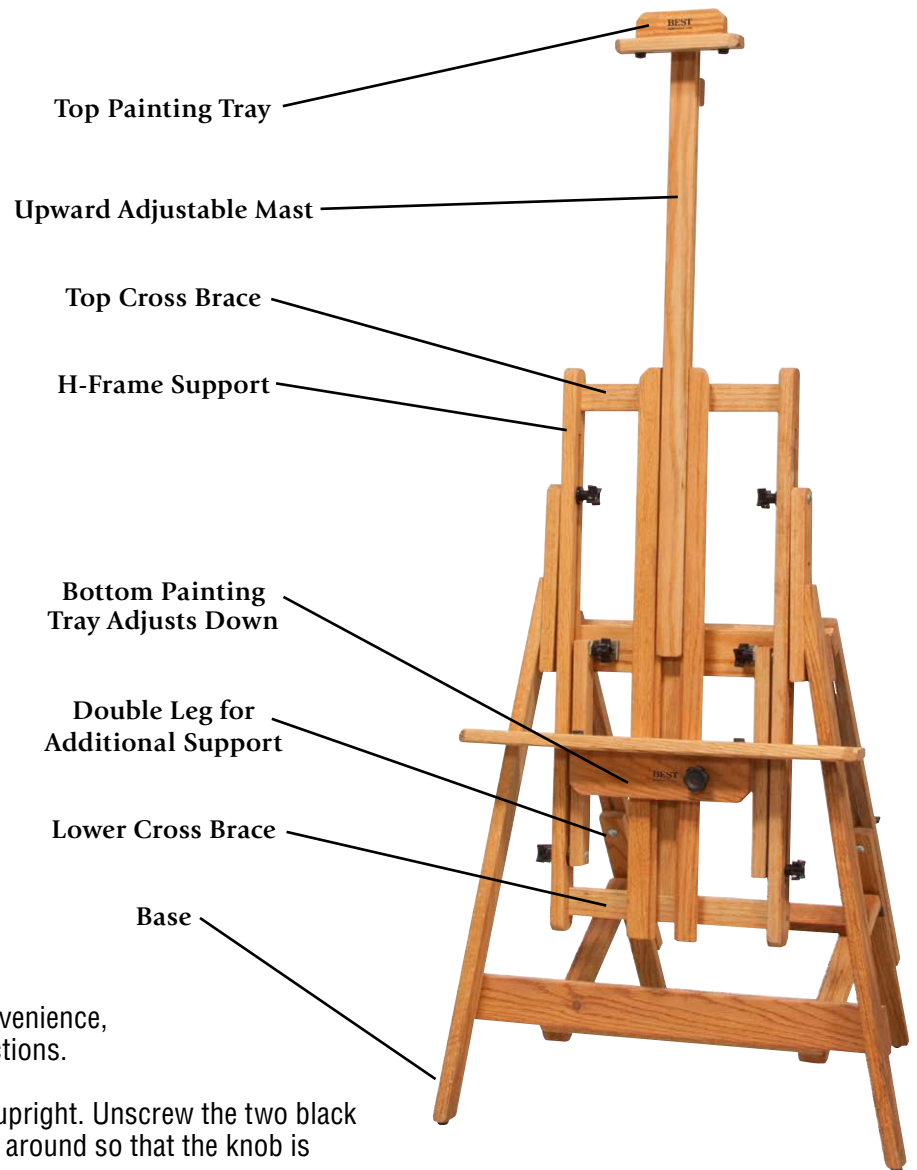

### Easel Assembly - Manzano

- 1.) Open box & lift easel out. For your convenience, the easel is pre-assembled into two sections.
- 2.) Fold out back legs and stand the easel upright. Unscrew the two black knobs on the back legs and flip the bolt around so that the knob is on the outside of the easel.
- 3.) Loosen the black knob that holds the mast in place. Remove mast.
- 4.) Install the bottom canvas holder onto the easel by sliding it over the mast channel. Tighten Wedge-Lok knob on tray to hold it in place.
- 5.) Reinstall the mast with the top canvas holder facing forward. Tighten back knob to hold mast in place.
- 6.) Your Manzano Easel should look like the image above when finished.